

studying together: sabbath school

Bible study groups begin at 9:30am and meet in a variety of locations (see map below). You're invited to attend any of the groups (there's a wide variety of topics being studied).

Children's classes meet in the east wing of our facility (except for the teens who meet in the Youth Chapel) and provide a great opportunity for your child to learn more about Jesus in a warm and safe environment.

An offering is taken during our study time and supports various mission projects as well as providing study materials for all age groups on Sabbath mornings.

study group locations

Whether you're a member or a guest, you're invited to attend any of the study groups:

- **Adult Quarterly:** *People on the Move: The Book of Numbers*—takes a look at Numbers in the context of the Cross and the New Covenant, revealing that God has already made His choice regarding us. The only question left is, What will be our choice regarding Him? (A: *Left rear of Sanctuary—Teacher: Norman Herron/Calmir Nielsen; C: Right front of Sanctuary—Teacher: Mike Wood*)
- **Bible Basics:** This small group takes a look at the basics of Christian Beliefs. (D: *Led by Jim Fraizer in the right rear of the Sanctuary*)
- **Living & Learning Verse by Verse:** Come join us for a lively discussion as we study the book of Matthew. (E: *Led Jim Brewster in Fellowship Room #1*)
- **Hispanic Class:** Continuaremos cada sábado, las reuniones en español estaremos aprendiendo a “Cómo compartir el amor de Jesús” (F: *Liderada por Norberto Liernur y Joel Obeso en Fellowship Hall #2*)

map

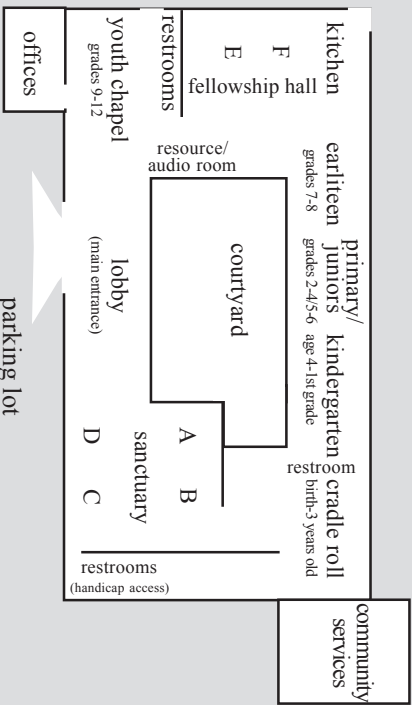

for your information

NOVEMBER'S NEWSLETTER is available in the lobby. Pick up yours today!

FELLOWSHIP LUNCH is today. Everyone is welcome! Join us for a meal hosted by the Excell Team. We ask that you bring plenty of prepared healthy vegetarian entrees/salads/desserts ready to serve!

BROAD SIDE OF THE BARN PARTY at the Porco's ranch **TONIGHT @ 5pm**. Dress warm and bring lawnchairs and blankets. Refreshments will be served followed by the movie *Fireproof*. If you need directions please call Mark @ 916-521-3930.

WORKBEE on the woodpile tomorrow (Sunday, November 15) from 8am-noon. There are several orders for cords that need to be cut and stacked.

CHURCH FINANCE & BOARD MEETING meets this Tuesday at 6 & 7pm.

CRADLE ROLL needs a pianist on the 1st and 4th Sabbaths. Please call Tracy Van Zant @ 530-878-2741 if you would be willing to help.

MARK YOUR CALENDAR FOR THE NEXT CHURCH HIKE! **November 21st** - we will be hiking the 2.5 mile round trip - Buttermilk Bend Trail near Point Defiance. Please meet in the church parking lot at 2:30 if you are interested in coming.

THE CHURCH OFFICE will be closed November 23 thru 30. Please call Pastor Dan @ 530-368-2922 if there is an emergency. The Bulletin for the 28th will be prepared on the 20th. Please submit any needed information by the 19th. Thank you!

MISSIONARY TRIP APPLICATION: March 14 to 25 members and friends of your church will be traveling to, San Antonio, Tlacamlico, Puebla, Mexico, and will begin building a school for our friends. They need our help, we need your help. We would like you personally on the trip. If you can't join us, please consider becoming a prayer partner for us and helping us financially. We need your application by December 1. Pick one up in the lobby, give it to the church office or mail it to Milton Kendrick, 4785 Beck Road, Auburn, CA 95602. Contact Milton @ 530-885-9223 or 916-802-2136

DONATIONS TO COMMUNITY SERVICES are what keep this vital ministry going. Thank you! What we need currently are: bed and bath linens; men's jeans; winter clothing (including long-sleeved shirts) for infants, children, and adults; warm jackets, hoodies, sweatshirts, and such; food; sleeping bags; tents; tarps (not blue); waterproof boots; and cash for the food and other supplies we must buy. Please keep your eyes open for good sale prices, and either purchase and donate the items yourselves, or let Kendall Porco or other Community Services volunteers know about them. Thank you for your continued generosity, and because we are still cramped for space, thank you for talking other donations to other facilities.

PINE HILLS VEGE FOOD STORE - REMINDER: Friday, November 20 is last day store will be open before Thanksgiving. For special delivery, or to make an evening appointment, call Diane Chang - 530-906-5498. Sandwich slices are back!—Smoked Turkey, Chicken, Corned Beef and Wham. Also in stock: Gardenburger, Soy Curris, Veg-Tuna (Tuno), Soy Cheese Pizza, Chili Man chili, Stonewall's Jerque, Companion Chai Pow Yu (soft gluten), and more! Visit during school hours.

COMMUNITY BREAKFAST has started up again. Volunteers are needed to cook. Please sign up on the list that is on the bulletin board or contact Steve Holm @ 916-425-6766.

WORSHIP SERVICE RECORDINGS are available in the Resource Center following today's service. CD's are \$3.00.

CHECK THE BULLETIN BOARD for additional information on area events and items of interest.

church calendar

Financial Report

2009-10 fiscal year:
as of November 7 week 19

Church Family Budget

received: \$54,739.46
needed: \$57,000.00

(funds not specifically marked are applied to the offering of the day)

Student Assistance Fund

received: \$9,770.04
needed: \$15,227.02

church staff

Dan Appel, senior pastor (530)392-3428
David Carreon, associate pastor (530)852-4770
Dick McDaniel, head elder (916)645-9811
Kathy Brewster, church clerk (530)887-1655
Joanne Pierson, office assistant (530)885-4232
Vic Anderson, principal (phaa) (530)885-9447
Kendall Porco, community services (530)823-0345
Norman Herron, head deacon
Susan Exceell, head deaconess
Jim Brewster, finance committee chairman
Don S Dyer, treasurer
Dan Knepp/Mark Porco, audio/visual

church office (530) 885-4232
office hours: monday-thursday; 9am-2pm
bulletin deadline: wednesday @ 2pm
church e-mail: aubsda@ascendence.net

15	sunday	22
Men's Basketball 5pm @ PHAA		Men's Basketball 5pm @ PHAA
16	monday	23
17	tuesday	24
Community Services 9:00am-1:00pm Finance Committee 6pm Church Board 7pm Men's Basketball 7pm @ PHAA		Community Service 9:00am-1:00pm Men's Basketball 7pm @ PHAA
18	wednesday	25
19	thursday	26
20	friday	27
4:47pm Sabbath begins		4:44pm Sabbath begins
21	sabbath	28
9:30-10:30am Sabbath School 10:45am Worship Giving Thanks		9:30-10:30am Sabbath School 10:45am Worship Dan Appel
4:47pm Sabbath end		4:43pm Sabbath ends

12225 rock creek road • auburn, ca 95602-2524
(530)885-4232 • fax (530)885-1231 • www.aubsda.org



worship service welcome

November 14, 2009

10:45am-12:15pm

To get the most out of worship today we recommend you:

1. *Be respectful of others* by turning off or silencing your cell phone.
2. *Use the Welcome Card located in front of you as you sit down.* It will help us become better acquainted and allow you to request information. Just check the appropriate boxes.
3. *Please don't feel obligated to participate in the offering.* The offering is intended for members and regular attenders who consider Auburn their church home. As our guest, we ask only that you place your Welcome Card in the offering plate when it is handed to you.

Welcome/Announcements Dan Appel

Singing Together

Children's Story Dave Van Zant

Baptism Chuck Straughan

Giving Back to God Scott Reiner

Annual Sacrifice

Prayer* Mas Masumbuko

Message in Music* Susan Carreon

Today's Message

Taking Our Mission Seriously

Milton Kindrick
Steve Holm
Mike Wood
Dan Appel

* Please wait during this time to enter the sanctuary

Next week's offering is for the *Auburn Church Budget* which helps support all the ministries here at Auburn.

Elder in charge: Brad Heisler
Organist: Kent Young

5. *Nursing mother's* may also care for their child in the Cradle Roll or Kindergarten rooms.
6. *Hearing assistance* is available. Please ask at the sound booth for an amplifier.

Our mission: to make and develop disciples for Jesus in a caring environment.