

studying together: sabbath school

Bible study groups begin at 9:30am and meet in a variety of locations (see map below). You're invited to attend any of the groups (there's a wide variety of topics being studied).

Children's classes meet in the east wing of our facility (except for the teens who meet in the Youth Chapel) and provide a great opportunity for your child to learn more about Jesus in a warm and safe environment.

An offering is taken during our study time and supports various mission projects as well as providing study materials for all age groups on Sabbath mornings.

study group locations

Whether you're a member or a guest, you're invited to attend any of the study groups:

- **Adult Quarterly:** *People on the Move: The Book of Numbers*—takes a look at Numbers in the context of the Cross and the New Covenant, revealing that God has already made His choice regarding us. The only question left is, What will be our choice regarding Him? (A: *Left rear of Sanctuary—Teacher: Norman Herron/Calmir Nielsen; C: Right front of Sanctuary—Teacher: Mike Wood*)
- **Bible Basics:** This small group takes a look at the basics of Christian Beliefs. (D: *Led by Jim Fraizer in the right rear of the Sanctuary*)
- **Living & Learning Verse by Verse:** Come join us for a lively discussion as we study the book of Matthew. (E: *Led Jim Brewster in Fellowship Room #1*)
- **Hispanic Class:** Continuaremos cada sábado, las reuniones en español estaremos aprendiendo a “Cómo compartir el amor de Jesús” (F: *Liderada por Norberto Liemur y Joel Obeso en Fellowship Hall #2*)

map

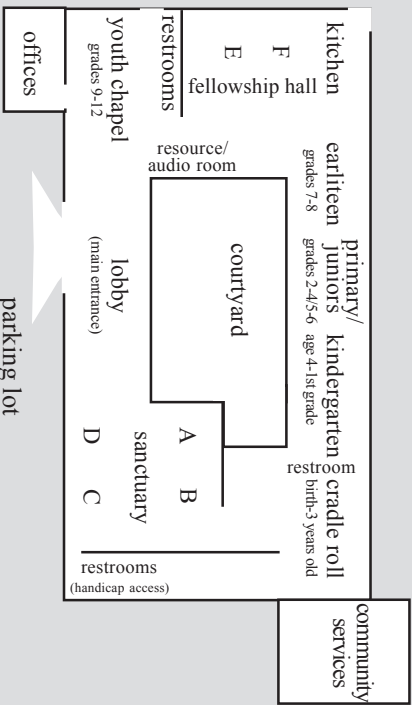

for your information

YEAR-END DONATIONS - PLEASE NOTE: In order for you to claim a deduction for contributions made to the church this year, we must receive your contributions by December 31, 2009. Contributions that you make in the new year cannot be deducted on this year's tax return, even if the check is dated this year. If a check is postmarked by December 31, 2009, it can be deducted this year. *The online giving deadline for 2009 is 9pm Pacific time, 12/31/2009.* You must pre-register to use online giving, so you must get that process done ahead of time. Just click on the online giving link at the top of a church website page (www.ahpsda.org). A BIG thanks to our church family for your regular generosity! — Don Dyer, Church Treasurer

COMMUNION service will be next Sabbath (January 2, 2010).

NEXT FELLOWSHIP LUNCH is January 9. Everyone is welcome! Join us for a meal hosted by the Horsman Team. We ask that you bring plenty of prepared healthy vegetarian entrees/salads/desserts ready to serve!

COMMUNITY BREAKFAST has started up again. Volunteers are needed to cook. Please sign up on the list that is on the bulletin board or contact Steve Holm @ 916-425-6766.

MEXICO MISSION TRIP – less than 90 days before we leave! It is time to start making reservations and ordering supplies. If you haven't turned your application in do it now. Airplane tickets will be purchased the first week in January as well as reservations for our side trips. Please make a payment of \$700 by December 31. *Participants or those that may want to go on the trip are invited to eat together during the January 9th Fellowship Lunch.* Need more information? Contact Milton Kindrick @ 916-802-2136 or evenings @ 530-885-9233.

DONATIONS TO COMMUNITY SERVICES are what keep this vital ministry going. Thank you! What we need currently are: bed and bath linens; men's jeans; winter clothing (including long-sleeved shirts) for infants, children, and adults; warm jackets, hoodies, sweatshirts, and such; food; sleeping bags; tents; tarps (not blue); waterproof boots; and cash for the food and other supplies we must buy. Please keep your eyes open for good sale prices, and either purchase and donate the items yourselves, or let Kendall Porco or other Community Services volunteers know about them. Thank you for your continued generosity, and because we are still cramped for space, thank you for taking other donations to other facilities.

NEW SABBATH SCHOOL CLASS – “SECOND LOOK” to begin January 9, 2010. Will meet in the front left section of the Sanctuary. Led by Pastor Dan. The Sermon topic of each week will be the discussion.

18-Day NEWSTART LIFESTYLE PROGRAM January 3-21, 2010 at Weimar Institute of Health & Education. We can help you reduce the risk of and reverse obesity, diabetes, heart disease, high cholesterol, hypertension, depression & other degenerative diseases. To invest in your health & future call 1-800-525-9192 or visit www.newstart.com

radKID is an exciting program for kids ages 5-7 & 8-12 that teaches children to know when and how to protect themselves from harm. The Sacramento Law Enforcement Chaplaincy teaches the classes. Classes will be Sundays 1:30-3:30pm on January 10, 17, 24, and 31. Cost is \$50 per child, second child in the family \$25. Children just wear running shoes and play clothes. Parents free. Call Rocklin church @ 916-624-4877 because class is limited.

ADDRESS FOR: Chuck & Lucille Gaede, 10722 Mead Lane, Loma Linda, CA 92354, phone is 909-253-1750.

WORSHIP SERVICE RECORDINGS are available in the Resource Center following today's service. CD's are \$3.00.

CHECK THE BULLETIN BOARD for additional information on area events and items of interest.

church calendar

Financial Report

2009-10 fiscal year:
as of December 19 week 25

Church Family Budget

received: \$69,688.34
needed: \$75,000.00

(funds not specifically marked are applied to the offering of the day)

Student Assistance Fund

received: \$14,471.28
needed: \$20,035.55

church staff

Dan Appel, senior pastor (530)392-3428
David Carreon, associate pastor (530)852-4770
Dick McDaniel, head elder (916)645-9811
Kathy Brewster, church clerk (530)887-1655
Joanne Pierson, office assistant (530)885-4232
Vic Anderson, principal (phaa) (530)885-9447
Kendall Porco, community services (530)823-0345
Norman Herron, head deacon
Susan Exceall, head deaconess
Jim Brewster, finance committee chairman
Don S Dyer, treasurer
Dan Knepp/Mark Porco, audio/visual

church office (530)885-4232
office hours: monday-thursday, 9am-2pm
bulletin deadline: wednesday @ 2pm
church e-mail: aubsda@ascendence.net

27	sunday	3
Men's Basketball 3pm @ PHAA		Men's Basketball 3pm @ PHAA
28	monday	4
Church Office closed		
29	tuesday	5
Community Services 9:00am-1:00pm		Community Service 9:00am-1:00pm
Men's Basketball 7pm @ PHAA		Men's Basketball 7pm @ PHAA
30	wednesday	6
31	thursday	7
1	friday	8
4:52pm Sabbath begins		4:58pm Sabbath begins
2	sabbath	9
9:30-10:30am Sabbath School 10:45am Worship Dan Appel Communion		9:30-10:30am Sabbath School 10:45am Worship Dave Carreon Fellowship Lunch
4:53pm Sabbath end		4:59pm Sabbath ends



worship service welcome

To get the most out of worship today we recommend you:

1. *Be respectful of others* by turning off or silencing your cell phone.
2. *Use the Welcome Card located in front of you as you sit down.* It will help us become better acquainted and allow you to request information. Just check the appropriate boxes.
3. *Please don't feel obligated to participate in the offering.* The offering is intended for members and regular attenders who consider Auburn their church home. As our guest, we ask only that you place your Welcome Card in the offering plate when it is handed to you.

December 26, 2009
10:45am-12:15pm

Welcome/Announcements Dan Appel
Singing Together
Giving Back to God Norm Herron
Auburn Church Budget

Prayer* Scott Reimer
Message in Music Nicole Toppel
Today's Message Dan Appel
Wise Men Still Seek Him

* *Please wait during this time to enter the sanctuary*

Next week's offering is also for the *Auburn Church Budget* which helps support all the ministries here at Auburn.

Elder in charge: Sally Christensen
Organist: Sten Bolander

4. *There is Child Care during the Worship time for ages 5 and under.* It is located in the Cradle Roll room. Go out the left side door in the Sanctuary, up the stairs and to the right.
5. **Nursing mother's** may also care for their child in the Cradle Roll or Kindergarten rooms.
6. *Hearing assistance* is available. Please ask at the sound booth for an amplifier.