

# studying together: sabbath school

**Bible study groups begin at 11:30am and meet in a variety of locations (see map below).** You're invited to attend any of the groups (there's a wide variety of topics being studied).

**Children's classes** meet in the east wing of our facility (except for the teens who meet in the Youth Chapel) and provide a great opportunity for your child to learn more about Jesus in a warm and safe environment.

**An offering** is taken during our study time and supports various mission projects as well as providing study materials for all age groups on Sabbath mornings.

## study group locations

*Whether you're a member or a guest, you're invited to attend any of the study groups:*

- **Adult Quarterly:** *The Fruit of the Spirit*—takes a look at Galatians 5:22, 23 not to focus on how we can become more patient or more loving or more gentle or more faithful but on how we can let the Holy Spirit make us more like Jesus, who is patience, love, gentleness, and faithfulness personified. (A: *Left rear of Sanctuary—Teacher: Norman Herron/Calmar Nielsen; C: Right front of Sanctuary—Teacher: Mike Wood*)
- **Second Look:** This group takes a deeper look at the sermon topic presented today. (B: *Led by Pastor Dan/Dave in the left front of the Sanctuary*)
- **Bible Basics:** This small group takes a look at the basics of Christian Beliefs. (D: *Led by Jim Fraizer in the right rear of the Sanctuary*)
- **Living & Learning Verse by Verse:** Come join us for a lively discussion as we study the book of Matthew. (E: *Led Jim Brewster in Fellowship Room #1*)
- **Hispanic Class:** Continuaremos cada sábado, las reuniones en español estaremos aprendiendo a “Cómo compartir el amor de Jesús” (F: *Liderada por Norberto Liennur y Joel Obeso en Fellowship Hall #2*)

# map

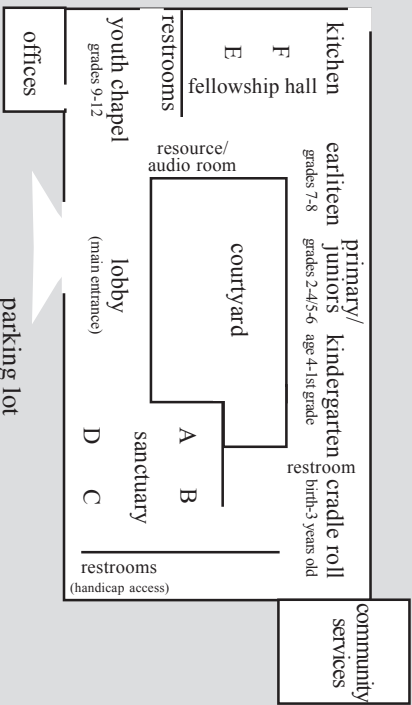

# for your information

**CHURCH PICTORIAL DIRECTORIES** are now available. Stop by the Resource Center today to pick up your copy. There is one per family to those who had their picture taken. Extra directories without photos are also available for those who did not get their picture into the directory.

**SNOWSHOEING TRIP** - February 28th come join us for an easy, beautiful afternoon of snowshoeing. See Pastor Dave or Mandy for more details.

**COMMUNITY BREAKFAST** time has been changed to 8:30am Sabbath mornings. Volunteers are needed to cook or to just help. Please sign up on the list that is in the kitchen or contact Steve Holm @ 209-245-3199.

**DINE OUT** with your 55 plus friends, Sunday, February 28 @ 3pm at Sizzler in Auburn. Please RSVP is a must to Yvonne Palmer @ 878-231 8 or the O'Haver's @ 268-2490 BEFORE Friday, February 26. See this month's newsletter for a few more details.

**NEXT FELLOWSHIP LUNCH** is March 13! Everyone is welcome! Join us following the Sabbath School Classes for a meal hosted by the Mehner Team. We ask that you bring plenty of prepared healthy vegetarian entrees/salads/desserts ready to serve! *We appreciate and thank the Excel team along with all who provided food for the delicious meal served last week.*

**DONATIONS TO COMMUNITY SERVICES** are what keep this vital ministry going. Thank you! What we need currently are: bed and bath linens; men's jeans; winter clothing (including long-sleeved shirts) for infants, children, and adults; warm jackets; hoodies, sweatshirts, and such; food; sleeping bags; tents; tarps (not blue); waterproof boots; and cash for the food and other supplies we must buy. Please keep your eyes open for good sale prices, and either purchase and donate the items yourselves, or let Kendall Porco or other Community Services volunteers know about them. Thank you for your continued generosity, and because we are still cramped for space, thank you for taking other donations to other facilities.

**THE CARMICHAEL CHURCH** is holding a "Jesus Series" during the month of February. You are invited to come each Friday evening at 7pm during the month of February and hear the following well-known Adventist speakers: Feb. 12, 13 Loren Setbold, Pastor, Worthington Adventist Church; Feb. 19, 20 Craig Newborn, Pastor, Oakwood University; Feb. 26, 27 Chris Oberg, Pastor, La Sierra University. The church is located at 4600 Winding Way, Sacramento.

**RIDE NEEDED** to church. Please contact Rebecca Siegel @ 888-8460. Lives on Timberlane in Auburn.

**THE CHURCH OFFICE** will be closed February 24 thru March 3. You may call either Pastor Dan @ 368-2922 or Pastor Dave @ 330-3863 as they will be in and out of the office during this time. *Please turn in any bulletin info for next week by Tuesday at noon.*

**WORSHIP SERVICE RECORDINGS** are available in the Resource Center following today's service. CD's are \$3.00.

**CHECK THE BULLETIN BOARD** for additional information on area events and items of interest.

## membership transfers (first reading)

- in:** Vanessa Castlebury from Grass Valley, CA  
**to:** Mark, Laura, Shelby Allen to Landsborough SDA Church, Landsborough, Queensland, Australia

# Financial Report

2009-10 fiscal year:  
as of February 13 week 33

## Church Family Budget

received: \$88,587.42  
needed: \$99,000.00

(Funds not specifically marked are applied to the offering of the day)

## Student Assistance Fund

received: \$19,536.51  
needed: \$26,446.92

Next week's offering is for the *local Conference Advance* which helps support various projects in the N. California Conference.

*Elder in charge:* Mas Masumbuko

*Deacon in charge:* Tim Barr

*Organist:* Patricia Loye

sunset this evening ~ 5:46pm

# church staff

Dan Appel, Senior Pastor (530)392-3428  
David Carreon, Associate Pastor (530)852-4770  
Dick McDaniel, Head Elder (916) 645-9811  
Kathy Brewster, Church Clerk (530)887-1655  
Joanne Pierson, Office Assistant (530)885-4232  
Vic Anderson, Principal (Phaa) (530)885-9447  
Kendall Porco, Community Services (530)823-0345  
Norman Herron, Head Deacon  
Susan Kxevell, Head Deaconess  
Jim Brewster, Finance Committee Chairman  
Don S Dyer, Treasurer  
Dan Knepp/Mark Porco, Audio/Visual

**church office (530) 885-4232**

**office hours: monday-thursday: 9am-2pm**

**bulletin deadline: wednesday @ 2pm**

**church e-mail: aubsda@ascendence.net**

12225 rock creek road • Auburn, ca 95602-2524  
(530)885-4232 • fax (530)885-1231 • www.aubsda.org

# church calendar

21	sunday	28
22	monday	1
23	tuesday Community Services 9:00am-1:00pm	2 Community Service 9:00am-1:00pm
24	wednesday	3
25	thursday	4
26	friday	5
27	sabbath 10:00am Worship Service 11:30-12:30pm Sabbath School Dan Appel	6 10:00am Worship Service 11:30-12:30pm Sabbath School Dan Appel
	5:54pm Sabbath end	6:01pm Sabbath ends



seventh-day adventist

**church**

February 20, 2010

10:00AM-11:15PM

# welcome

**We Gather For Worship**

**Worship in Giving**

*Auburn Church Budget*

**Worship in Prayer\***

Sally Christensen

**Message in Music\***

Keith Cordis

**Today's Message**

Dan Appel

*Be True!*  
Revelation-part five

\* *Please wait during this time to enter the sanctuary*

Sabbath School Classes to follow for all ages

**To get the most out of worship today we recommend you:**

~ *Be respectful of others* by turning off or silencing your cell phone.

~ *Use the Welcome Card located in front of you as you sit down.* It will help us become better acquainted and allow you to request information. Just check the appropriate boxes.

~ *Please don't feel obligated to participate in the offering.* The offering is intended for members and regular attendees who consider Auburn their church home. As our guest, we ask only that you place your Welcome Card in the offering plate when it is handed to you.

~ *There is Child Care during the Worship time for ages 5 and under.* It is located in the Cradle Roll room. Go out the left side door in the Sanctuary, up the stairs and to the right.

~ *Nursing mother's* may also care for their child in the Cradle Roll or Kindergarten rooms.

~ *Hearing assistance* is available. Please ask at the sound booth for an amplifier.

OUR MISSION: TO MAKE AND DEVELOP DISCIPLES  
FOR JESUS IN A CARING ENVIRONMENT