

studying together: sabbath school

Bible study groups begin at 10:00am and meet in a variety of locations (see map below). You're invited to attend any of the groups (there's a wide variety of topics being studied).

Children's classes meet in the east wing of our facility (except for the teens who meet in the Youth Chapel) and provide a great opportunity for your child to learn more about Jesus in a warm and safe environment.

An offering is taken during our study time and supports various mission projects as well as providing study materials for all age groups on Sabbath mornings.

study group locations

Whether you're a member or a guest, you're invited to attend any of the study groups:

- **Living & Learning Verse by Verse:** Come join us for a lively discussion as we study the book of Mark. (**E:** Led by Jim Brewster in Fellowship Hall-room #2)
- **Adult Quarterly: The Gospel in Galatians--**Takes a look at the apostle Paul as he pleads with the Galatians to remain true to Jesus. At the same time, it also gives us a chance to reflect on our own understanding of the gospel. (**A:** Left rear of Sanctuary--**Teacher: Norman Herron B: Front right of Sanctuary-- Teachers: Dick McDaniel/ Mike Wood)**
- **Hispanic Class:** Continuaremos cada sábado, las reuniones en español. Estaremos aprendiendo a "Cómo compartir el amor de Jesús". (*Meets in the Hispanic Class Room*)

map

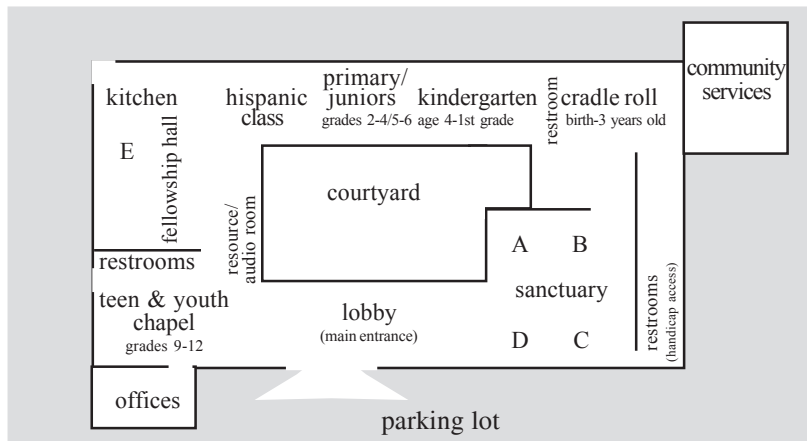

for your information

SERVICIO EN ESPANOL comienza a las 9.30am hasta las 11.00am Escuela Sabatica. Culto Divino alas 11.15am hasta las 12.30pm. (meets in the Hispanic Class Room) Para mas informacion llamar a Dalila Vargas 916-205-9708.

THE BENEVOLENT FUND taken today following the communion service is an opportunity to help assist members who are facing tough times or financial difficulties.

YEAR-END DONATIONS - PLEASE NOTE: In order for you to claim a deduction for contributions made to the church this year, we must receive your contributions by December 31, 2011. Contributions that you make in the new year cannot be deducted on this year's tax return, even if the check is dated this year. If a check is postmarked by December 31, 2011, it can be deducted this year. The deadline for 2011 online giving is midnight- Pacific time on Saturday, Dec 31, 2011. A BIG thanks to our church family for your regular generosity! — Don Dyer, Church Treasurer

THE CHURCH OFFICE will be closed on January 2.

NEXT FELLOWSHIP LUNCH IS January 14. Join us for a meal hosted by the Horsman team. Everyone is welcome! We ask that you bring plenty of prepared healthy vegetarian entrees/salads/ desserts ready to serve to share with our guests.

LAUGH YOUR WAY TO A BETTER MARRIAGE presents a two-day Video Seminar at our church on Friday, January 27 from 6:00pm-9:00pm and Saturday, January 28 from 6:00pm-9:30pm. Couples are \$35, singles are \$18. This is a wildly entertaining and informative marriage event designed to bring hope and positive change to marriages. It creates better communication in marriages, helps spouses better understand each others' needs, and rekindles romance in marriage relationships. Laugh Your Way to a Better Marriage appeals widely to men, even those who may typically resist marriage ministry! **You must register for this event**, either go online to our website aubsda.org and at the bottom of our main page there is a link to click or call toll free 866-52-LAUGH (866.525.2844).

SHERRY SWISHER wishes to express her gratefulness for the support and prayers of her church family.

VICKIE CLIFFORD (former member from '88-'95) passed away December 15. Her Memorial Service will be held Saturday, January 7, 4 pm at the Roseville Adventist Church, 914 Cirby Way, Roseville, CA. A reception will follow the service. If you would like to send a gift, please contribute to the Vickie Clifford Memorial Fund in lieu of flowers. Contact the church office for information.

MUSICAL LEGEND Ralph Carmichael & his 16-piece big band will be performing a live concert of Gospel music on Thursday evening, January 19, 2012, @ 7:00pm at the Napa Community Seventh-day Adventist Church. For concert and ticket information, go to www.napasdachurch.com.

LIVE-STREAMING of our worship service has now resumed! Go to www.aubsda.org and click on "church service live". Previously recorded services are also available to watch.

COMMUNITY BREAKFAST meets @ 8:30am Sabbath mornings. **Volunteers are needed to cook or to just help.** Please sign up on the list that is in the kitchen or contact Steve Holm @ 209-245-3199.

WORSHIP SERVICE RECORDINGS are available in the Resource Center following today's service. CD's are \$3.00.

CHECK THE BULLETIN BOARD for additional information on area events and items of interest.

membership transfers (second reading)

in: Cheryl Haggerty from Mt. Vernon Hill SDA Church
Dave & Susan Kaplan from Monterey Bay Academy SDA Church

to: David & Mandy Nash to Carmichael SDA Church

Financial Report

2011-12 fiscal year:
as of December 24, week 26

Church Family Budget

received: \$65,653.46
needed: \$83,221.15

(funds not specifically marked are applied to the offering of the day)

Student Assistance Fund

received: \$13,419.56
needed: \$17,307.69

Next week's offering is for the *Auburn Church Budget* which helps support all the ministries here at Auburn.

Elder in Charge: Steve Holm
Deacon in Charge: John Kaster
Audio-visual: Dan Knepp
Pianist: Kent Young

sunset this evening ~ 4:51pm

church staff

Dan Appel, Senior Pastor (530)392-3428
David Carreon, Associate Pastor (530)852-4770
Jim Brewster, Admin Pastor (530)887-1655
Dick McDaniel, Head Elder (916)645-9811
Kathy Brewster, Church Clerk (530)887-1655
Joanne Pierson, Admin Assistant (530)885-4232
Vic Anderson, Principal (PHAA) (530)885-9447
Kendall Porco, Community Services (530)823-0345
Norman Herron, Co-Head Deacon (530)878-2105
Maxine Mehner, Co-Head Deacon (530)885-4232
Rodney Wehtje, Finance Chair (530)885-4232
Don S Dyer, Treasurer (530)885-4232
Dan Knepp, Audio Visual (916)991-9151
Mark Porco, Audio Visual (916)521-3930

church office (530)885-4232
office hours: monday-thursday, 9am-2pm
bulletin deadline: wednesday @ 2pm
church e-mail: office@aubstda.net

12225 rock creek road • auburn, ca 95602-2524
(530)885-4232 • fax (530)885-1231 • www.aubstda.org

church calendar

1	sunday	8
	New Years Day	
2	monday	9
	Church Office closed	
3	tuesday	10
	Community Services 9:00am-1:00pm	Community Service 9:00am-1:00pm
4	wednesday	11
5	thursday	12
	Volleyball 6:00-8:00pm PHAA	Volleyball 6:00-8:00pm PHAA
6	friday	13
	4:56pm Sabbath begins	5:03pm Sabbath begin
7	sabbath	14
	10:00am Sabbath School 11:15-12:30pm Worship Service Dan Appel	10:00am Sabbath School 11:15-12:30pm Worship Service Dan Appel Fellowship Lunch Heritage Singers Concert @ 6pm
	4:57pm Sabbath ends	5:04pm Sabbath ends



December 31, 2011 - 11:15am-12:30pm

OUR MISSION: TO MAKE AND GROW
PASSIONATE FOLLOWERS OF JESUS IN A NURTURING ENVIRONMENT
THROUGH WORSHIP, RELATIONSHIPS, AND SERVICE.

Welcome

We Gather For Worship

Baptism

Juliette Ashlock
Gara McLearn

Worship in Giving

NAD Outreach

Dick McDaniel

Today's Message

Dan Appel

Celebration of Forgiveness**

You're invited to participate or simply observe. Men are invited to go to the Youth Chapel, Women to the Primary Room and Couples/Families to the Fellowship Hall

Message in Music*

Celebration of New Life

The Benevolent Fund offering will be taken at the sanctuary doors following the service

* **Please wait during this time to enter the sanctuary**

** Visitors are welcome to quietly worship in the Sanctuary during this time, take part, or quietly observe.

To get the most out of worship today we recommend:

- ~ *Be respectful of others* by turning off or silencing your cell phone.
- ~ *Use the Welcome Card located in front of you as you sit down.* It will help us become better acquainted and allow you to request information. Just check the appropriate boxes.
- ~ *Please don't feel obligated to participate in the offering.* The offering is intended for members and regular attenders who consider Auburn their church home. As our guest, we ask only that you place your Welcome Card in the offering plate when it is handed to you.
- ~ *Nursing mother's* may care for their child in the Mother's Room located off to the left of the Sanctuary.
- ~ *Hearing assistance* is available. Please ask at the sound booth for an amplifier.