

Financial Report

2013-14 fiscal year:
as of June 21, week 51

Church Family Budget

received: \$164,319.15
needed: \$174,576.92

(funds not specifically marked are applied to the offering of the day)

Building Fund

Goal \$50,000.00

received: \$26,132.74
needed: \$23,867.26

Student Assistance Fund

received: \$15,247.85
needed: \$19,811.54

Next week's offering is for the *Auburn Church Budget* which helps support all the ministries here at Auburn.

Elder in Charge: Chris Stokes
Deacon in Charge: John Kaster

sunset this evening ~ 8:34pm

church staff

Dan Appel, Senior Pastor (530)392-3428
David Carreon, Associate Pastor (530)852-4770
Jim Brewster, Admin Pastor (530)887-1655
Tulio Robinson, Head Elder (530)885-4232
Kathy Brewster, Church Clerk (530)887-1655
Joanne Pierson, Admin Assistant (530)885-4232
Vic Anderson, Principal (PHAA) (530)885-9447
Kendall Porco, Community Services (530)823-0345
Norman Herron, Head Deacon (530)820-3573
Rodney Wehtje, Finance Chair (530)885-4232
Don S Dyer, Treasurer (530)885-4232
Mike Wood, Audio Visual (530)885-4232

Community Services, Tuesday 9-1 (530)823-0345
Auburn Renewal Center, Tues/Fri (530)887-8673

church office (530)885-4232
office hours: monday-thursday, 9am-2pm
bulletin deadline: wednesday @ 2pm
church e-mail: office@aubnsda.net

church calendar

29	sunday	6
30	monday	7
1	tuesday	8
Community Services 9:00am-1:00pm		Community Services 9:00am-1:00pm
2	wednesday	9
3	thursday	10
Volleyball 6:00-8:00pm PHAA		Volleyball 6:00-8:00pm PHAA
4	friday	11
8:33pm Sabbath begins		8:31pm Sabbath begins
5	sabbath	12
10:00am Sabbath School 11:15-12:30pm Worship Service Jim Brewster		10:00am Sabbath School 11:15-12:30pm Worship Service Dave Carreon
Church Picnic-1:30pm @ Meadow Vista Park		
8:33pm Sabbath ends		8:31pm Sabbath ends



June 28, 2014

BECAUSE WE BELIEVE JESUS IS RETURNING, OUR MISSION IS:
TO ATTRACT AND GROW PASSIONATE FOLLOWERS OF JESUS THROUGH
WORSHIP, RELATIONSHIPS, AND SERVICE.

THE CARING CHURCH

IF THIS IS NOT A PLACE
WHERE TEARS ARE UNDERSTOOD,
WHERE DO I GO TO CRY?
IF THIS IS NOT A PLACE
WHERE MY SPIRIT CAN TAKE WING,
WHERE DO I GO TO FLY?

IF THIS IS NOT A PLACE
WHERE MY QUESTIONS CAN BE ASKED,
WHERE DO I GO TO SEEK?
IF THIS IS NOT A PLACE
WHERE MY FEELINGS CAN BE HEARD,
WHERE DO I GO TO SPEAK?

IF THIS IS NOT A PLACE
WHERE YOU'LL ACCEPT ME AS I AM,
WHERE DO I GO TO BE?
IF THIS IS NOT A PLACE
WHERE I CAN TRY AND LEARN AND GROW,
WHERE CAN I JUST BE ME?

OUR DREAM IS THAT THE AUBURN ADVENTIST CHURCH CAN BE A PLACE
WHERE PEOPLE, HURT AND DAMAGED BY LIFE AND BY RELIGION, CAN MEET
JESUS AND COMMIT TO FOLLOWING HIM. WE INVITE YOU TO JOIN US IN
DISCOVERING HIS POWER TO HEAL ALL OF OUR PAIN AND DYSFUNCTION AND TO
MAKE US MORE THAN WE HAVE EVER DREAMED THAT WE COULD BE.

12225 rock creek road • auburn, ca 95602-2524
(530)885-4232 • fax (530)885-1231 • www.aubnsda.org

studying together: sabbath school

Bible study groups begin at 10:00am and meet in a variety of locations (see map below). You're invited to attend any of the groups (there's a wide variety of topics being studied).

Children's classes meet in the east wing of our facility (except for the teens who meet in the Youth Chapel) and provide a great opportunity for your child to learn more about Jesus in a warm and safe environment.

An offering is taken during our study time and supports various mission projects as well as providing study materials for all age groups on Sabbath mornings.

study group locations

Whether you're a member or a guest, you're invited to attend any of the study groups:

- **A Conversation About the Scriptures:** Come join us for a lively discussion as we study the Gospel of John. The Gospel of John was written to prove that Jesus Christ is the Son of God. As an eyewitness to the love and power displayed in the life and teachings of Jesus, John gives us an up-close and personal look at Christ's identity. He shows us that Jesus, though fully God, came in the flesh to distinctly and accurately reveal God, and that Christ is the source of eternal life to all who believe in him. (**E:** Led by Jim Brewster/Jeff Pierson/Brian Toppel in Fellowship Hall-rooms #1 & #2)
- **Adult Quarterly: Christ and His Law** — takes a look at the law, especially the question of why so many Christians—misunderstanding the relationship between law and grace—have fallen into the trap of denying the continued validity of the Ten Commandments thus, unwittingly helping the attempt to “overthrow” God's law. The Bible, though, is clear: “For this is the love of God, that we keep His commandments” (1 John5:3). The link between our loving God and the keeping of His commandments is stronger than we realize. (**A:** Left rear of Sanctuary—Teacher: Norman Herron **B:** Front right of Sanctuary— Teachers: Dick McDaniel/Mike Wood)
- **Hispanic Class:** Continuaremos cada sábado, las reuniones en español. Estaremos aprendiendo a “Cómo compartir el amor de Jesús”. (*Meets in the Hispanic Class Room*)

map

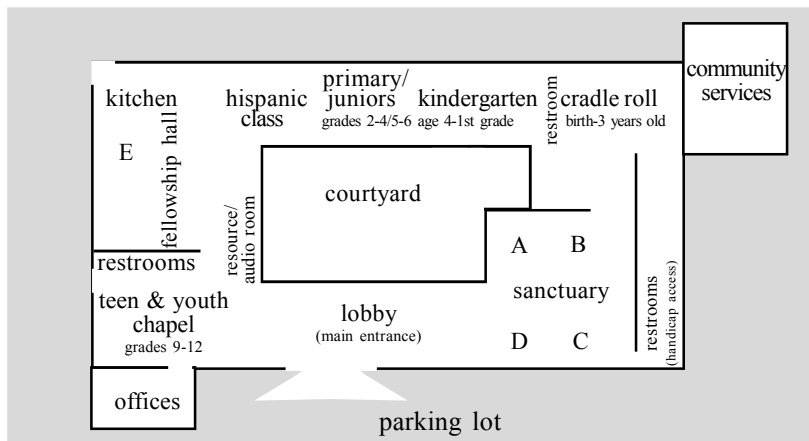

worship service

11:15am - 12:30pm

We Gather For Worship

Children's Story

Dave Krussow

Worship in Giving

Sally Christensen

Local Conference Advance

Offertory - Megan Carreon

Today's Message

Dan Appel

Let Go of the Rock

Celebration of Forgiveness*

You're invited to participate or simply observe. Men are invited to go to the Youth Chapel, Women to the Primary Room and Couples/Families to the Fellowship Hall

Celebration of New Life

The Benevolent Fund offering will be taken at the sanctuary doors following the service

*Visitors are welcome to quietly worship in the Sanctuary during this time, take part, or quietly observe.

To get the most out of worship today we recommend:

- ~ **Fill out the Welcome Card located in front of you as you sit down.** It will help us become better acquainted and allow you to communicate with us your needs and/or request information. Just check the appropriate boxes and be sure to write your name and contact info so that we can follow up and simply place the card in the offering plate.
- ~ **Be respectful of others** by turning off or silencing your cell phone.
- ~ **Please don't feel obligated to participate in the offering.** The offering is intended for members and regular attenders who consider Auburn their church home. As our guest, we ask only that you place your Welcome Card in the offering plate when it is handed to you.
- ~ **Nursing mothers** may care for their child in the Mother's Room located off to the left of the Sanctuary.
- ~ **Hearing assistance** is available. Please ask at the sound booth for an amplifier.

for your information

SERVICIO EN ESPANOL comienza a las 9:30am hasta las 11:00am Escuela Sabatica. Culto Divino alas 11:15am hasta las 12:30pm. (meets in the Hispanic Class Room) Para mas informacion

CHURCH ELDERS will be at the front of the church immediatly following each Worship Service to pray with anyone who may wish to do so.

JULY'S CHURCH NEWSLETTER is available in the lobby. Pick up yours today!

TODAY we will celebrate the Lord's Supper during the Worship Service.

THE BENEVOLENT FUND offering that is taken at the Sanctuary doors following the communion service today helps to assist members who are facing tough times or financial difficulties.

THE NOMINATING COMMITTEE FINAL REPORT will be voted on during the Worship Service announcement time today. You may pick up a copy of this in the lobby.

AN UPDATED CHURCH DIRECTORY is available. Please stop by the Resource Center to pick up your copy!

NEXT FELLOWSHIP LUNCH is July 12 – Please join us following the Worship Service – everyone is welcome! For summertime simplicity, we ask that you please bring plenty of vegetarian picnic style entrees/salads/desserts that require no oven/stove use and are all ready prepared and ready to just set on the table to share with our guests.

CHURCH CAMPOUT 2014 ~ at Fallen Leaf Lake Campground on September 5 & 6. It's time to start planning. Right now all the sites from #175 to #188 are open. That gets us on one arm of the #170 to #193 loop. Go online to recreation.gov or call 1-877-444-6777 for reservations. I will remind you and send you information as the time gets closer. Call Susan Excell @ 530-878-4429.

WE ARE SADDENED to learn that long time member Martha Jura quietly and peacefully passed away this last Wednesday. Please remember her family with prayer.

CELEBRATE RESTORATION AND RENEWAL (CRR) ~ A time and place to discover God's power to restore and renew you - no matter the pain that you feel, the problems life has dealt you or the habits which chain you. Fridays from 7pm-8:30pm here at the church.

WORSHIP SERVICE RECORDINGS are available in the Resource Center following today's service. CD's are \$4.00ea. You may also find them online at our church webpage under "media library" as downloads or streaming.

LIVE-STREAMING of our worship service can be viewed by going to www.aubds.org and click on "church service live". Previously recorded services are also available.

COMMUNITY BREAKFAST meets @ 8:30am Sabbath mornings. **Volunteers are needed to cook or to just help.** Contact Steve Holm @ 209-245-3199.

CHECK THE BULLETIN BOARD for additional information on area events and items of interest.

membership transfers

(final reading)

in: Michelli Rojas-Hawkins from Valley View SDA Church, Medford, OR.