

STUDYING TOGETHER: SABBATH

Bible study groups begin at 10:00am and meet in a variety of locations (see map below). You're invited to attend any of the groups studying a wide variety of topics.

Children's classes meet in the east wing of our facility (except for the teens who meet in the Youth Chapel) and provide a great opportunity for your child to learn more about Jesus in a warm and safe environment.

An offering is taken during our study time and supports various mission projects as well as providing study materials for all age groups on Sabbath mornings.

STUDY GROUP LOCATIONS

Whether you're a member or a guest, you're invited to attend any of the study groups:

- **A Conversation About the Scriptures:** January 31st and February 7th - How to understand "God's Wrath". February 14th and 21st "Unanswered Prayers". February 28th and March 7th - What happened at the Cross? - The Atonement. (Team led by Jim Brewster/Jeff Pierson/Brian Toppel in Fellowship Hall-room #1)
- **Adult Quarterly: The Book of Proverbs:** The Book of Proverbs teaches about what it means to follow God in our daily lives. Proverbs provides down-to-earth advice for daily living. (A: Left rear of Sanctuary—Teacher: Norman Herron B: Front right of Sanctuary— Teachers: Mike Wood)

WORSHIP SERVICE

February 7, 2015

11:15am - 12:30pm

We Gather For Worship

Children's Story

Dave Krussow

Worship in Giving

Jim Brewster

Church Family Budget

Worship in Prayer

Brian Toppel

Today's Message

Dan Appel

"God's Time to Recreate"

Isaiah 58:13-14

TO GET THE MOST OUT OF WORSHIP TODAY WE RECOMMEND:

- ~ **Fill out the Welcome Card located in front of you as you sit down.** It will help us become better acquainted and allow you to communicate with us your needs and/or request information. Just check the appropriate boxes and be sure to write your name and contact info so that we can follow up and simply place the card in the offering plate.
- ~ **Be respectful of others** by turning off or silencing your cell phone.
- ~ **Please don't feel obligated to participate in the offering.** The offering is intended for members and regular attenders who consider Auburn their church home. As our guest, we ask only that you place your Welcome Card in the offering plate when it is handed to you.
- ~ **Nursing mothers** may care for their child in the Mother's Room located off to the left of the Sanctuary.
- ~ **Hearing assistance** is available. Please ask at the sound booth for an amplifier.

map

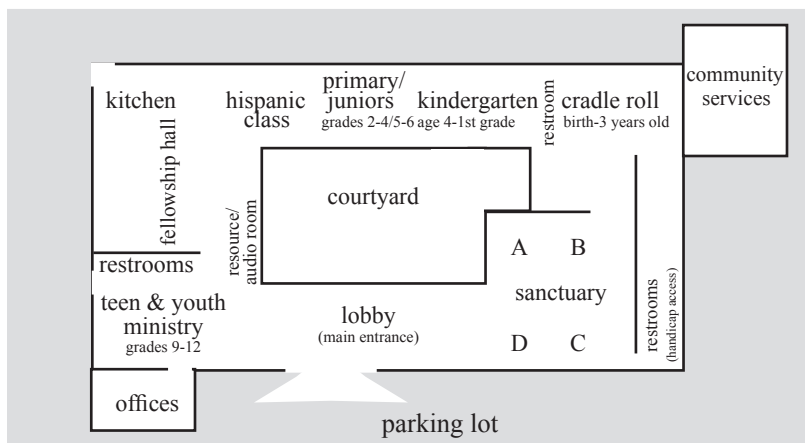

Financial Report
2014-15 fiscal year:
as of January 31, 2015, week 31

Church Family Budget

Received: \$112,110.36
Needed: \$106,115.38

Building Fund

Goal \$50,000.00

Received: \$47,363.83
Needed to reach goal: \$ 2,636.17

Student Assistance Fund

Received: \$ 13,271.00
Needed: \$ 14,903.85

Next week's offering is for Church Benevolent Fund

CHURCH STAFF

Dan Appel, Senior Pastor	(530)392-3428
David Carreon, Associate Pastor	(530)852-4770
Jim Brewster, Admin Pastor	(530)887-1655
Tulio Robinson, Head Elder	(530)885-4232
Kathy Brewster, Church Clerk	(530)887-1655
Vic Anderson, Principal (PHAA)	(530)885-9447
Kendall Porco, Community Services	(530)823-0345
Norman Herron, Head Deacon	(530)820-3573
Rodney Wehtje, Finance Chair	(530)885-4232
Jenell Wareham, Treasurer	(530)885-4232
Community Services	(530)823-0345
Auburn Renewal Center	(530)887-8673



BECAUSE WE BELIEVE JESUS IS RETURNING, OUR MISSION IS:
TO ATTRACT AND GROW PASSIONATE FOLLOWERS OF JESUS THROUGH
WORSHIP, RELATIONSHIPS, AND SERVICE.

THE CARING CHURCH

IF THIS IS NOT A PLACE
WHERE TEARS ARE UNDERSTOOD,
WHERE DO I GO TO CRY?

IF THIS IS NOT A PLACE
WHERE MY SPIRIT CAN TAKE WING,
WHERE DO I GO TO FLY?

IF THIS IS NOT A PLACE
WHERE MY QUESTIONS CAN BE ASKED,
WHERE DO I GO TO SEEK?

IF THIS IS NOT A PLACE
WHERE MY FEELINGS CAN BE HEARD,
WHERE DO I GO TO SPEAK?

IF THIS IS NOT A PLACE
WHERE YOU'LL ACCEPT ME AS I AM,
WHERE DO I GO TO BE?

IF THIS IS NOT A PLACE
WHERE I CAN TRY AND LEARN AND GROW,
WHERE CAN I JUST BE ME?

OUR DREAM IS THAT THE AUBURN ADVENTIST CHURCH CAN BE A PLACE
WHERE PEOPLE, HURT AND DAMAGED BY LIFE AND BY RELIGION, CAN MEET
JESUS AND COMMIT TO FOLLOWING HIM. WE INVITE YOU TO JOIN US IN DIS-
COVERING HIS POWER TO HEAL ALL OF OUR PAIN AND DYSFUNCTION AND TO
MAKE US MORE THAN WE HAVE EVER DREAMED THAT WE COULD BE.

FOR YOUR INFORMATION

SERVICIO EN ESPANOL comienza a las 9:30am hasta las 11:00am Escuela Sabatica. Culto Divino alas 11:15am hasta las 12:30pm. (meets in the Hispanic Class Room) Para mas informacion **CHURCH ELDERS** will be at the front of the church immediatly following each Worship Service to pray with anyone who may wish to do so.

NEXT FELLOWSHIP LUNCH Our next Fellowship Lunch will be February 14, 2015.

CELEBRATE RESTORATION AND RENEWAL (CRR) ~A time and place to discover God's power to restore and renew you - no matter the pain that you feel, the problems life has dealt you or the habits which chain you. Fridays from 7pm-8:30pm here at the church.

WORSHIP SERVICE RECORDINGS are available in the Resource Center following today's service. CD's are \$4.00ea. You may also find them online at our church webpage under "media library" as downloads or streaming.

LIVE-STREAMING of our worship service can be viewed by going to www.aubnsda.org and click on "church service live". Previously recorded services are also available.

FEBRUARY NEWSLETTER Pick up a copy of the February Newsletter in the Lobby.

NCC WOMEN'S MINISTRIES CONFERENCE The Northern California Conference Women's Ministries department is planning a Women in Service and Leadership Conference on February 27 and February 28 at the Orangevale Seventh-day Adventist Church. Brochure/application forms can be found on the cradanza in the lobby.

SWEETHEART VALENTINE'S DAY DINNER The Auburn Pathfinder Club is sponsoring a Sweetheart Valentine's Day Dinner in the Fellowship Hall on February 14 at 5:00pm. The only thing you need to bring is your sweetheart.

PHAA OPEN HOUSE You are invited to the PHAA "Student Visitation Day" Wednesday, February 25 from 8:00am - 12:30pm. This is an opportunity to meet the teachers and students as you anticipate joining us next year. Please call the school office at (530) 885-9447 to RSVP or with any questions.

NCC PRAYER RETREAT The 14th Annual NCC Prayer Retreat will be held on March 13-15 at Leoni Meadows. Applications are available on the credenza in the lobby.

PHAA MUSICAL The PHAA Performing Arts Department will present the musical Annie on February 21 at 7:00pm, February 22 at 2:00pm, February 29 at 7:00pm, and March 1 at 2:00pm. Tickets may be purchased online through the PHAA website at www.phaaonline.com.

MEMBERSHIP TRANSFERS First Reading - Transfer Out - Dick and Yvonne McDaniel to Lincoln SDA Church.

AUBURN RENEWAL CENTER CLINIC HOURS

Tuesday, February 10, 2015 - 9:00am - 1:00pm
 Saturday, February 14, 2014 - 2:00pm - 6:00pm
 Tuesday, February 17, 2015 - 9:00am - 1:00pm

CALENDAR FEBRUARY 8, 2015 - FEBRUARY 21, 2015

SUNDAY	8		SUNDAY	15
MONDAY	9		MONDAY	16
TUESDAY	10	Community Services 9:00am - 1:00pm Auburn Renewal Center 9:00am - 1:00pm	TUESDAY	17
WEDNESDAY	11	5:30pm - Common Links	WEDNESDAY	18
THURSDAY	12	Volleyball PHAA 6:00pm - 9:00pm	THURSDAY	19
FRIDAY	13	7:00pm - Celebrate Recovery 5:38pm - Sabbath Begins	FRIDAY	20
SABBATH	14	8:30am Community Breakfast 10:00am - Sabbath School 11:15 - Worship Service Dan Appel & Dave Carreon 5:39pm- Sabbath Ends	SABBATH	21
				6:00pm Finance Committee
				Community Services 9:00am - 1:00pm Auburn Renewal Center 9:00am - 1:00pm
				7:00pm - Celebrate Recovery 5:46pm - Sabbath Begins
				8:30am Community Breakfast 10:00am - Sabbath School 11:15 - Worship Service Dan Appel 5:47pm- Sabbath Ends